

# Para Image™

## Aluminum III Eggcrate

- Heat Dissipating
- Non-Flammable
- Easy Maintenance
- 4 Cell Sizes: 1/2" ~ 3/4" ~ 1" ~ 2"

The Para Image Aluminum III “eggcrate” is a non-parabolic aluminum louver that eliminates glare and brightness, is economical and versatile, and very easy to clean and maintain. The Para Image Aluminum III has an open grid non-flammable design, allowing use in air ventilation applications and for concealing fire sprinkler systems (be sure to check with prevailing fire codes). The product is produced from a high quality aluminum material that is available in a broad range of colors and finishes. Although we do not stock every option, we do carry inventory on many of the most popular selections.

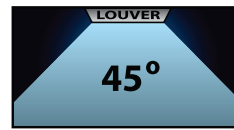

### Technical Data

Shielding angle: 45°  
V.C.P. 99%

### Standard Color or Finish Choices

Anodized = A      Mill Finish = M  
Black Enamel = B      White Enamel = W

*Color Choices: Please specify your choice of color as a suffix to the end of our part number.*

Smoke = S      Red = R      Pink = P      Amber = A  
Green = GR      Blue = B      Deep Purple = DP      Bug Yellow = BY      Ultra Violet Filtering = UV

## ORDERING INFORMATION:

### Cell size 1/2" x 1/2" x 1/2"

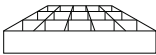

| Dimensions        | Color**  | Part #          | Carton Quantity | Carton Weight |
|-------------------|----------|-----------------|-----------------|---------------|
| 23 3/4" x 47 3/4" | - call - | LI-PA3-50-24F__ | 20              | 35 lbs        |
| 23 5/8" x 47 5/8" | - call - | LI-PA3-50-24__  | 10              | 35 lbs        |

\*\* Also available in other sizes, colors and finishes as a custom product, please call.  
When ordering please provide cut size. Cut to: \_\_\_\_\_ x \_\_\_\_\_ ie. 11 3/4" x 47 3/4"

### Cell size 3/4" x 3/4" x 3/4"

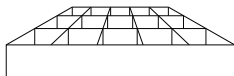

| Dimensions        | Color**  | Part #         | Carton Quantity | Carton Weight |
|-------------------|----------|----------------|-----------------|---------------|
| 23 3/4" x 47 3/4" | - call - | LI-PA3-75-24__ | 7               | 55 lbs        |

\*\* Also available in other sizes, colors and finishes as a custom product, please call.  
When ordering please provide cut size. Cut to: \_\_\_\_\_ x \_\_\_\_\_ ie. 11 3/4" x 47 3/4"

### Cell size 1" x 1" x 1"

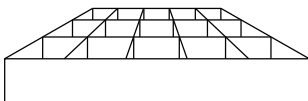

| Dimensions        | Color**  | Part #          | Carton Quantity | Carton Weight |
|-------------------|----------|-----------------|-----------------|---------------|
| 23 3/4" x 47 3/4" | - call - | LI-PA3-100-24__ | 5               | 40 lbs        |

\*\* Also available in other sizes, colors and finishes as a custom product, please call.  
When ordering please provide cut size. Cut to: \_\_\_\_\_ x \_\_\_\_\_ ie. 11 3/4" x 47 3/4"

### Cell size 2" x 2" x 2"

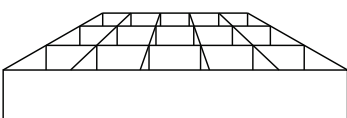

| Dimensions        | Color**  | Part #          | Carton Quantity | Carton Weight |
|-------------------|----------|-----------------|-----------------|---------------|
| 23 3/4" x 47 3/4" | - call - | LI-PA3-200-24__ | 3               | 30 lbs        |

\*\* Also available in other sizes, colors and finishes as a custom product, please call.  
When ordering please provide cut size. Cut to: \_\_\_\_\_ x \_\_\_\_\_ ie. 11 3/4" x 47 3/4"